

← SEE NEXT PAGE

Distributors in the United States and Canada provide a standard Limited Warranty for 6 months from the date of purchase for new products. If you're not located in the United States or Canada, please contact your local distributor for warranty arrangements in your territory. Please visit www.seadooseascooter.com for distributor/Service Centre details. Distributors ONLY warrant Stallion products purchased from an authorized dealer.

Ask your local Distributor for the warranty period in your region by calling their Service Center. Any part of the product supplied by the Distributor and found in the reasonable judgment of the Distributor to be defective in material or workmanship will be repaired or replaced by the Distributor without charge for parts or labor. The product including any defective part must be sent to the Distributor within the warranty period. The customer will pay for the expense of delivering the product to the Distributor. The Distributor will pay for the expense of returning the product to the customer.

ALWAYS ACTIVATE YOUR WARRANTY IMMEDIATELY ON
<http://www.seadooseascooter.com/warranty.html>

**Distributors ONLY warrant products with an active
Warranty Registration**

WARRANTY & CUSTOMER SERVICE INFORMATION

www.seadooseascooter.com



SEA-DOO

User Manual English Version

SDP95001



SEA-DOO® SEASCOOTER™ Aquanaut

Model no. ZS19 / SD5543

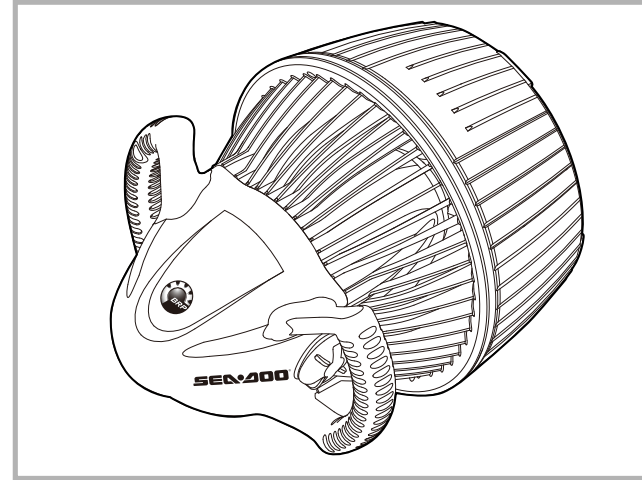

CAUTION

ELECTRICALLY OPERATED PRODUCT
Not recommended for children under 8 years of age. As with all electrical products, precautions should be observed during handling and used to reduce the risk of electric shock.

Contents

Introduction	1
Parts diagram	2
WARNING & CAUTION	3
Getting Started	5
Battery use	7
Care & Maintenance	14
- Storing the Aquanaut	14
- Rechargeable Battery and Charger Care	14
- Accidental Flooding	15
- Removing Blockage From Propeller	16
Trouble Shooting	18
Technical Specifications	19
FFC Statement	20

Instruction

The SEA-DOO® SEASCOOTER™ Aquanaut gives kids a totally new experience - power performance for fun and excitement in the pool.

Please take a little time to study this manual before using your Aquanaut.

1

Parts Diagram

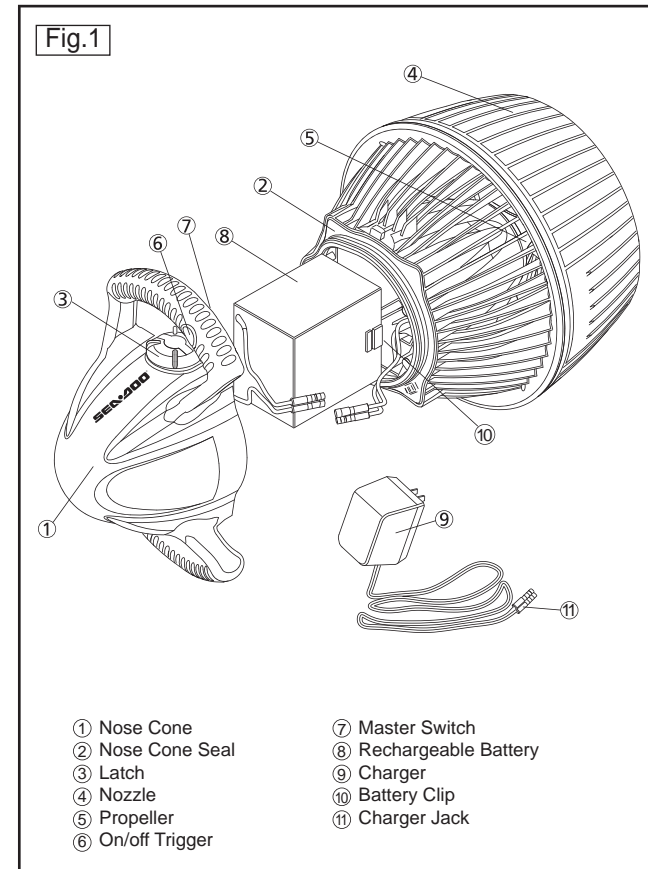

2

WARNING

WARNING:

CHOKING HAZARD - Small parts Not for children under 3 years

This is not a life saving device. Do not leave children unattended while device is in use.

Only to be used in water in which the child is within its depth and under supervision.

- Read the User Manual carefully before using the AQUANAUT.
- Keep the packaging since it contains important information.
- Do not operate the AQUANAUT for long periods out of the water to avoid damage.
- The AQUANAUT must be assembled by an adult.
- The AQUANAUT is designed to hold ONE person not exceeding 100 lbs/45kg.
- always wear a Approved Personal Flotation Device / Approved Life-Preserver when using the AQUANAUT.
- Not to be used by children under the age of eight (8) and must ONLY be used by children under adult supervision. An adult must be responsible for battery safety at all times, during use, storage and charging.
- The AQUANAUT is for pool use only - DO NOT use in the open sea.
- Never stick body parts, clothing or other objects in the vicinity of the propeller.
- DO NOT wear loose or flowing clothing that could be drawn into the propeller.

3

WARNING

- Particular care should be exercised when using the AQUANAUT near anybody with long hair.
- User with long hair should tie it up or wear a swimming cap when using the AQUANAUT.
- ALWAYS inspect the area to ensure it is free of hazards or obstacles such as swimmers before using the AQUANAUT.
- ALWAYS ensure sufficient charges remains in the battery to return to the poolside before using the AQUANAUT.
- Always charge battery to its fullest before using the AQUANAUT. After charging is complete the battery will continue to off gas. Wait at least 30 minutes after charging before removing the battery from the charger or placing the battery into the battery housing. Failure to do so could result in an explosion.
- ALWAYS remove the battery from the unit when not in use.
- Do not use alcohol or mind-altering drugs prior to using this product.
- ALWAYS keep the AQUANAUT out of direct sunlight when not in use. HEAT KILLS BATTERIES.
- DO NOT store the battery in the unit.

4

Getting Started

When you buy the SEA-DOO® SEASCOOTER™ AQUANAUT the battery is disconnected and needs to be charged.

Follow the safety cautions on page 7 to 10 and charging instructions on pages 11 to 13.

Using the AQUANAUT

1. Charge the battery and install just before use.
2. Make sure your child is wearing a coast guard approved flotation device when using the Aquanaut.
3. Place the Aquanaut into the water. The Aquanaut should float.
4. When ready to set off, switch the Master Switch to the 'On' position. (see fig. 2)

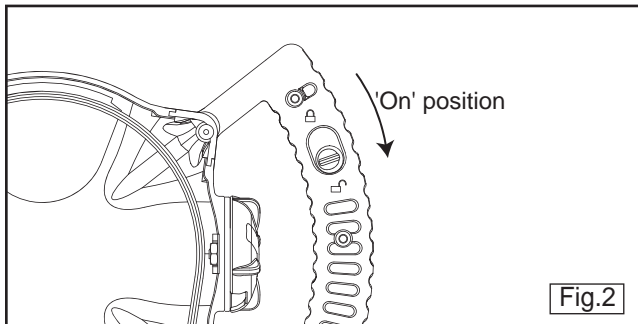

5. Pull and hold the trigger to start the propeller. (There is a short delay before the Propeller begins to rotate).
6. To stop the propeller, simply release the trigger.
7. Always set Master Switch to the 'Off' position when out of the water. (see fig. 3)

5

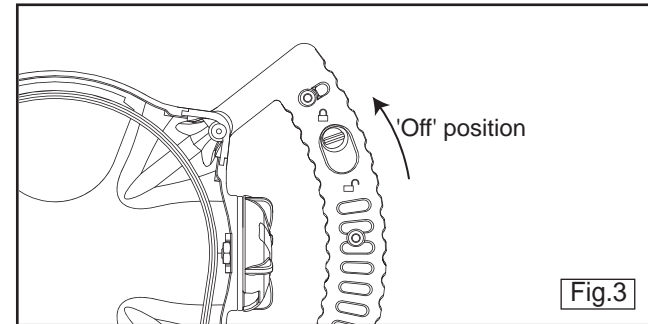

6

Battery Use



WARNING
BATTERY SAFETY

RE-CHARGE THE BATTERY
AT LEAST **EVERY 3 MONTHS**

- Must remove and store the battery separately from the unit when not in use!
- Must re-charge the battery after use **WITHIN 24 HOURS**.
- Must re-charge the battery at least **EVERY THREE MONTHS** when not in use.

User Manual must be read and understood before use.

No warranty for the battery, Please read and follow the Battery Safety Instruction

Incorrect battery maintenance may reduce the battery life and influence its function.

www.seadooseascooter.com

7

Battery Use

CAUTION

- Your SEA-DOO® SEASCOOTER™ AQUANAUT is supplied with a battery that needs to be treated carefully as it will release potentially explosive gasses during its normal cycle of use (off gassing). Please read the entire manual thoroughly and follow all instructions. Failure to do so can result in an explosion occurring.
- Always remove the battery from your SEA-DOO® SEASCOOTER™ AQUANAUT when it is not in use and store separately in a well ventilated area where it is out of the reach of children and away from heat and ignition sources.
- Do not install the battery in your SEA-DOO® SEASCOOTER™ AQUANAUT until immediately prior to using it.
- Before disconnecting/connecting any cables, open the nose cone and allow two minutes for any explosive gases to dissipate.
- Do not use/store/charge the battery in temperatures above 40°C (104°F) as excessive off gassing may occur. Keep the battery and AQUANAUT in the shade when not in use.
- Always ensure the unit is dried thoroughly before opening the Nose Cone.
- Only use the charger supplied with the SEA-DOO® SEASCOOTER™ AQUANAUT.
- The battery supplied with your SEA-DOO® SEASCOOTER™ AQUANAUT releases a potentially explosive gas during charging. Charging should only take place in a well ventilated area, away from children and naked flames or other ignition sources (cigarettes, sparks). Never charge the battery whilst still in the SEA-DOO® SEASCOOTER™ AQUANAUT.

8

Battery Use

CAUTION

- Charge the battery as soon as possible after use within 24 hours.
- Always charge the battery to the fullest before using the SEA-DOO® SEASCOOTER™ AQUANAUT.
- Always remove the battery from the battery housing before charging.
- Always connect charger jack to the battery first and then plug charger into the mains.
- After charging, disconnect from the mains first and then disconnect the battery from the charger.
- After charging is complete the battery will continue to off gas. Wait at least 30 minutes after charging before removing the battery from the charger or placing the battery into the battery housing. Failure to do so could result in an explosion.
- Do not place battery into your SEA-DOO® SEASCOOTER™ AQUANAUT until immediately before use.
- Remove battery from charge once fully charged.
- Never charge the battery in a sealed container.
- Never charge the battery near water.
- Never short circuit the battery or battery connectors.
- Always ensure the charger is dry before use.
- The charger gets quite warm in use – this is normal.
- If in doubt of the state of the battery, recharge it until the indicator on the battery charger indicates a full charge.

9

Battery Use

CAUTION

- If the battery is not to be used for an extended period, store it in a well ventilated area away from children, heat and ignition sources and recharge it every three months to maintain charge and avoid excess off gassing. DO NOT store the battery inside the SEA-DOO® SEASCOOTER™ AQUANAUT.
- If the battery appears damaged or will not charge fully, the battery must be replaced. If battery life is noticeably reduced, the battery should be replaced.
- Exhausted batteries are to be removed from the toy.
- Battery must be recharged under adult supervision.
- ALWAYS charge battery in a well-ventilated place out of reach of children.
- The battery supplied with your SEA-DOO® SEASCOOTER™ AQUANAUT should last about 200 cycles or two years before it should be replaced. Please contact your local customer service centre/distributors. Using a battery in excess of these recommendations can result in excessive off gassing of explosive gas.
- The Rechargeable Battery will give you approximately one hour of use - always make sure you have enough power left to return to the poolside.
- Any battery charger/transformer to be used with the toy should be regular examined for potential hazards, such as damage to the cable or cord, plug, enclosure or other parts, and that, in the event of such damage, the toy must not be used until that damaged has been properly removed.
- When the SEA-DOO® SEASCOOTER™ AQUANAUT speed drops it is time to recharge the battery. Do not continue to use the SEA-DOO® SEASCOOTER™ AQUANAUT after the speed drops, until it stops, otherwise the battery will be damaged.

10

Battery and Charger Ratings:
Rechargeable Battery: 12V/4.5Ah
Charger: Output 12V/500mA

Charging The Rechargeable Battery

For battery charging follow these instructions.

1. Always ensure that the Master Switch is in the 'Off' position. (see fig. 3)
2. Always ensure that the Aquanaut is out of the water, dry and placed in a dry area.
3. Unclip the latches and remove the Nose Cone. (see fig. 4)

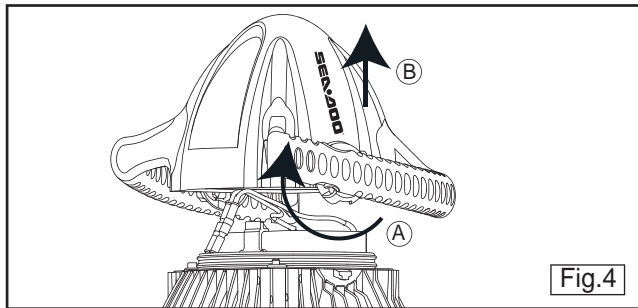

4. Allow two minutes for any gasses to dissipate.
5. Disconnect the battery cable from the housing cable (if not already disconnected - the cable will be disconnected when you buy your Aquanaut) (see fig. 5)

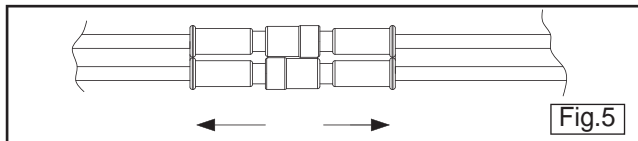

11

6. Remove the battery from the Aquanaut and place on a level surface.
7. Connect the battery cable to the charger cable.
8. Plug charger into mains, and turn on the supply.
9. Charging will take 10-12 hours for a fully discharged battery. When the battery is charging the red LED is on, when the battery is charged the green LED turns on.
10. Unplug the charger from the mains.
11. Allow battery to stand for 30 minutes before using it.
12. Unplug the battery cable from the charger cable.
13. When ready for use, install battery and reconnect to the housing cable.
14. Make sure the Nose Cone Seal. (see fig. 6) is clean and lubricated with silicone grease (you can buy this at your local hardware store).

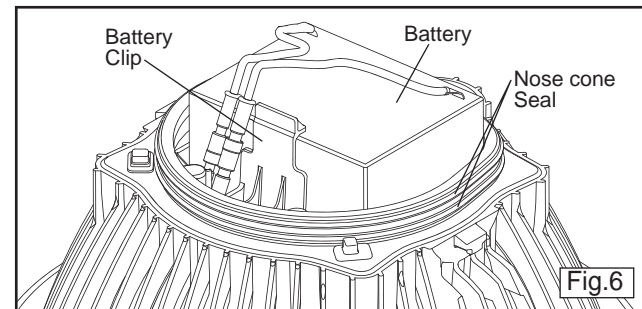

12

Care And Maintenance

15. Replace the Nose Cone and turn and lock the latches - you will hear a click when they are locked. (see fig.7)

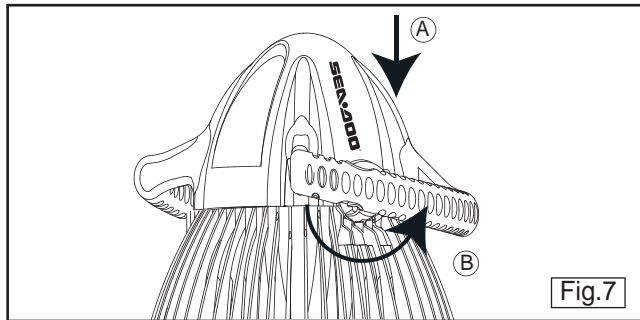

The Aquanaut is now ready to be used.

Replacing a flat battery with a fully charged battery.

1. Follow the steps 1 to 5 above
2. Remove the flat battery.
3. Install the charged battery.
4. Follow steps 13 and 15.

Buying Rechargeable Batteries

It is a good idea to have a second battery so that when one has run out you can swap it over with a charged one. Contact your local customer service centre/distributor to purchase additional rechargeable batteries.

13

Storing the Aquanaut

1. Always rinse the Aquanaut in fresh water and allow it to dry before storage.
2. Open the Nose Cone and remove the Rechargeable Battery (see also section on Rechargeable Battery and Charger Care for more storage information).
3. DO NOT store battery in Aquanaut.
4. Store the Aquanaut in the original box in a dry place.
 - ambient temperature for storage should be within -20°C to 40°C (-4°F to 104°F).
5. Always store the Aquanaut vertically.

Rechargeable Battery and Charger Care

1. Please read and understand important Battery Use safety information on pages 7, 8, 9 and 10.
2. The battery supplied with your SEASCOOTER™ should last about 200 cycles or two years before it should be replaced. Please contact your supplier. Using a battery in excess of these recommendations can result in excessive of gassing of explosive gas.
3. ALWAYS remove the battery from the SEASCOOTER™ immediately after use.
4. **DO NOT STORE BATTERY IN SEASCOOTER™**

14

Accidental Flooding

Always sure the Nose Cone Seal (see fig.6) is clean, lubricated with silicone grease and undamaged and the Nose Cone Latches are fully closed.

However, should the seal not to be cleaned properly or the latches are not fully closed and water enters the battery compartment, your Aquanaut will not be permanently damaged since it is designed for protection against flooding.

If the Battery Compartment floods:

1. Remove the Aquanaut from the water immediately and set the master switch to locked position. (see fig.3)
2. Unclip the latches and remove the Nose Cone and tip out excess water. (see fig.4)
3. Wait two minutes for any gases to dissipate.
4. Unplug the rechargeable battery and remove from the Aquanaut and dry completely.
5. If salt water has entered, rinse battery and battery housing with fresh water.
6. Dry housing and battery thoroughly.
7. Check rechargeable battery for damage, if it shows any sign of damage contact customer service for a replacement.
8. Reinstall the rechargeable battery and reconnect to the housing cable.
9. Make sure the Nose Cone Seal (see fig.6) is clean and lubricated with silicone grease and undamaged.
10. Replace the Nose Cone and turn and lock the latches - you will hear a click when they are locked. (see fig.7)

Removing Blockage From Propeller

If the propeller is blocked:

1. Remove the Aquanaut from water and dry completely.
2. Make sure the Master Switch is in the 'Off' position. (see fig.3)
3. Remove battery - see page 11, steps 1 to 5.
4. Unscrew rear grille screw and remove Nozzle. (see fig. 8)

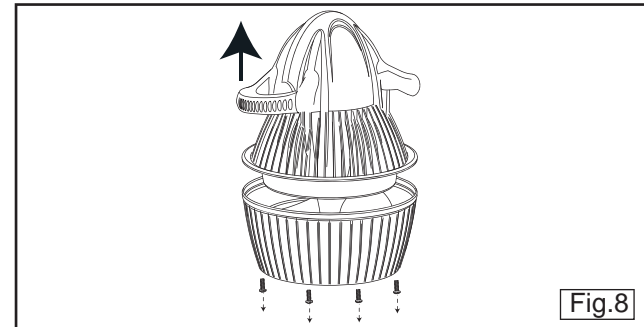

Fig.8

5. Straighten and then remove the split pin. (see fig.9)

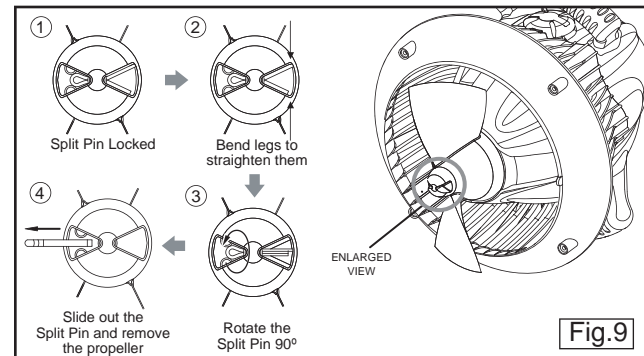

Fig.9

Trouble Shooting

6. Remove the propeller and then any blockage.
7. Replace propeller, insert split pin and bend the legs (see fig.10)

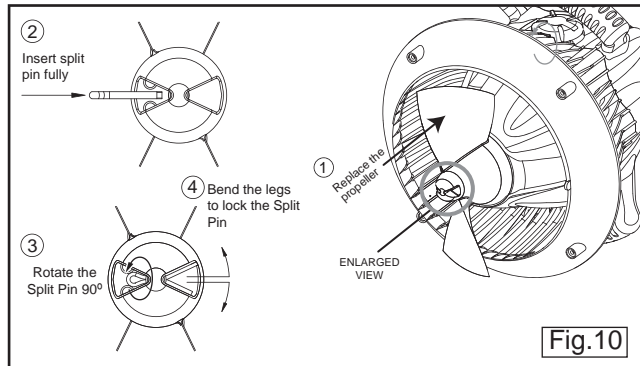

Fig.10

8. Replace the Nozzle.

If the Aquanaut will not start:

1. Make sure the Rechargeable battery is fully charged. (see Charging the Rechargeable Battery)
2. Make sure the Rechargeable Battery and housing cable are connected well.
3. Make sure the Master Switch is in the 'On' position. (see fig.2)
4. Make sure the Battery Compartment is dry, - if not follow instructions on page 15 for 'Accidental Flooding'.
5. Make sure the propeller is not blocked, - if it is follow steps on page 16, 'Removing Blockage from Propeller'.

Technical Specifications

Unit Dimensions	L 10.5 x W 10.5 x H 13.3" (265.5 x 265.5 x 338 mm)
Unit Weight (with battery)	7.34 lbs (3.34kg)
Battery Type	1 x rechargeable battery
Battery duration	Approximately 1 hour
Speed	Up to 2mph (3.2km/h)

FCC Statement

This device complies with Part 15 of the FCC Rules. Operation is subject to the following two conditions :
(1) this device may not cause harmful interference, and
(2) this device must accept any interference received, including interference that may cause undesired operation.

Warning : Changes or modifications to this unit not expressly approved by the party responsible for compliance could void the user authority to operate the equipment.

NOTE : This equipment has been tested and found to comply with the limits for a Class B digital device, pursuant to Part 15 of the FCC Rules. These limits are designed to provide reasonable protection against harmful interference in a residential installation. This equipment generates, uses and can radiate radio frequency energy and, if not installed and used in accordance with the instructions, may cause harmful interference to radio communications.

However, there is no guarantee that interference will not occur in a particular installation. If this equipment does cause harmful interference to radio or television reception, which can be determined by turning the equipment off and on, the user is encouraged to try to correct the interference by one or more of the following measures:

- Reorient or relocate the receiving antenna.
- Increase the separation between the equipment and receiver.
- Connect the equipment into an outlet on a circuit different from that to which the receiver is connected.
- Consult the dealer or an experienced radio/TV technician for help.

**For more information on
Sea-Doo® Seascooter™ Products
(Warranty, Customer Care / Maintenance,
Parts & Battery Purchase)**

PLEASE VISIT
www.seadooseascooter.com

Distributed by **Stallion (asia) LTD.**
Block F, 6/F, Wah Hing Industrial Mansions
36 Tai Yau Street, San Po Kong, Kowloon, Hong Kong

Products covered by the following patents:

USA, Canada, EU, Australia, Japan, Hong Kong, China & Turkey
US D471,506S / US D518,768S / D527,702S / US D506,176S / US D507,776S
D512,678S / D519,911S / 6848385 B2 / US 7000559 B2 / US 7093554 B1 / 11/102.302
0500577.8 / 0500578.0 / 0500579.2 / HK1072691 / ZL200530005661.5
ZL200430079550.4 / ZL200430057359.X / ZL200530005662.X / ZL200530005663.4
ZL200320103738.8 / ZL200520008894.5 / 1194933 / 1254107 / 1225250
000330311-0001 / 000183900-0001 / 000183900-0002 / 000330279-0001
000330295-0001 / 03020902.7 / 302949 / 302564 / 302563 / 302950
302948 / 2005100230 / 200503474 / 29/268,724 / 11/595,675 / 000816376-0001

Toll Free: 1-877-2650996
service@stallionsport.com
www.stallionsport.com



SEA-DOO® and the BRP logo are trademarks
of Bombardier Recreational Products Inc. or its affiliates,
used under licence to Stallion (asia) Ltd.
For more information on SEA-DOO® products visit www.sea-doo.com

Stallion
P r o d u c t

Patented Print in China

This warranty does not cover any product that has been subject to misuse or negligence or accident, or that has been operated in any way contrary to the operating instructions as specified in the User Manual. This warranty does not apply to any damage to the product that is the result of improper maintenance or to any product that has been altered or modified so as to change its intended use. This warranty does not extend to repairs made necessarily by normal wear or by the use of parts or accessories which are either incompatible with the product or adversely affects its operation, performance or durability.

In addition, this warranty does not cover items that experience normal wear and tear. ALL IMPLIED WARRANTIES ARE LIMITED IN THE DURATION TO THE WARRANTY PERIOD. AND SUCH IMPLIED WARRANTIES INCLUDING MERCHANTABILITY, FITNESS FOR A PARTICULAR PURPOSE, OR OTHERWISE, ARE DISCLAIMED IN THEIR ENTIRETY AFTER THE EXPIRATION OF THE APPROPRIATE WARRANTY PERIOD. THE DISTRIBUTOR'S OBLIGATION UNDER THE WARRANTY IS STRICTLY AND EXCLUSIVELY LIMITED TO THE REPAIR OR REPLACEMENT OF DEFECTIVE PARTS AND RETURN OF THE PRODUCT TO THE CUSTOMER. THE DISTRIBUTOR DOES NOT ASSUME OR AUTHORIZE ANYONE TO ASSUME FOR THEM ANY OTHER OBLIGATION.

THE DISTRIBUTOR ASSUMES NO RESPONSIBILITY FOR INCIDENTAL, CONSEQUENTIAL OR OTHER DAMAGES INCLUDING, BUT NOT LIMITED, TO EXPENSE OF RETURNING THE PRODUCT TO THE DISTRIBUTOR, LOSS OF USE OF PRODUCT AND LOSS OF TIME OR INCONVENIENCE.

EXCLUSIONS

BATTERY. This warranty does not include the battery.

CUSTOMER ENQUIRIES

If your unit is not operating, please refer to your User Manual before contacting our Customer Service Centre. For any damage or repair work required, please do not return your product to the store where it was purchased.

RETURN / REPAIR POLICY

Customers must call our Customer Service Centre and ask for a Return / Repair Authorization Number before sending the product to the Service Centre. Returned products must be shipped with original packaging including the polystyrene packing material and all defective parts. Please contact our Customer Service Centre for assistance in handling your case.

UNITED STATES SEA-DOO® SEASCOOTER™ CUSTOMER SERVICE CENTRE
Phone No.: +1-800-361-2781 Email: warranty-usa@seadooseascooter.com

CANADA SEA-DOO® SEASCOOTER™ CUSTOMER SERVICE CENTRE
Phone No.: +1-888-388-8837 Email: warranty-can@seadooseascooter.com

WESTERN EUROPE SEA-DOO® SEASCOOTER™ CUSTOMER SERVICE CENTRE
Phone No.: +44 (0)1709 515157 Email: john@alphad.org

EASTERN, SOUTHERN AND CENTRAL EUROPE SEA-DOO® SEASCOOTER™ CUSTOMER SERVICE CENTRE
Phone No.: +386 5616 50 20 Email: service@kernsport.com

HONG KONG SEA-DOO® SEASCOOTER™ CUSTOMER SERVICE CENTRE
Phone No.: +852 3516 2388 Email: service@stallionasia.com

(For other territories, please visit www.seadooseascooter.com and contact your local distributor)

RETURN / REPAIR PROCEDURE

1. Call the Customer Service Centre for your Return / Repair Authorization Number.
 2. Make a copy of your Proof of Purchase (receipt).
 3. Pack the defective unit in its original packaging including the polystyrene foam and include the unit and all defective parts.
 4. Attach the copy of your Proof of Purchase (receipt) to the outside of the box (clearly visible), together with the Return / Repair Authorization Number.
 5. Ship the package to the Service Centre.
- PLEASE NOTE:** Deliveries that do not have the Proof of Purchase (receipt) and Return / Repair Authorization Number attached clearly to the outside of the box, will not be accepted by the Service Centre.

For any questions or queries you may have regarding your SEA-DOO® SEASCOOTER™, please follow the below steps for easy and fast resolution:

- STEP 1-

Please read your User Manual. For a copy of the User Manuals, please visit www.seadooseascooter.com

- STEP 2-

Go to www.seadooseascooter.com and see our FAQ section to find instant answers.

- STEP 3-

Contact one of our Customer Service representatives at the Customer Service Centre in your region.